

COSWORTH

Colour Displays

CDU 10.3

QUICK LINKS

- [Overview](#)
- [Dimensions](#)
- [Installation](#)
- [Connector Information](#)
- [Recycling and Environmental Protection](#)

CDU 10.3

Overview

- 10.3" TFT Display
- Fully configurable display
- Fully configurable RGB LEDs
- USB Ethernet Logging
- 1000nit daylight readable

Cosworth's CDU range of displays continues to grow with the 10.3. The CDU 10.3 incorporates a high resolution, daylight readable 1000nit display with a resolution of 1280 x 480.

The widescreen aspect ratio and form factor results in an optimal display size to present comprehensive and clear information to motorsport drivers and other similar applications.

The CDU 10.3 also features USB logging meaning Cosworth data files can now be logged to USB via the CDU 10.3.



The data is received via Ethernet from a Cosworth device which also controls the full display templates, LEDs and brightness configuration. Multiple displays can also be linked and configured from a single Cosworth control device and setup.

All of this is packaged in an ultra slim aluminum case of only 23mm thick.

Electrical Data	
Operating Voltage	6 to 32V
Current Consumption ^(max)	~1A @ 14.4V
Communication	
Ethernet	2 x 100MB/S
USB Ports	1x USB2 (logging only)
Mechanical Data	
Size	283.4 x 122.2 x 23.19 mm
Weight	874 grams
Environmental	IP66
Material	6802-T2 Anodized
Vibration	Cosworth DV-V (C)
Operating Temp	-10°C to + 70°C
Storage Temp	-20°C to + 70°C

Display Data	
Screen	TFT LCD active matrix
Resolution	1280 x 480 QVGA
Viewable Area	243.84 x 91.44mm
Contrast Ratio	900:0
Brightness	1000 nit
Display Colours	16.8M
Viewable Angle	D90° U80° L&R 90°
LEDs	24 x RGB LEDs

Ordering Information

Description	Part Number
CDU 10.3	01D-640060
CDU 10.3 Bench Loom	60D-640026

Compatible Devices

Compatible Devices	
Badenia 2	01L-650100
Badenia 5	01L-650080
Centaurus 5	01I-610100
CLU	01L-650001
Antares	01E-501120
MQ12Di (coming soon)	01E-501085

Software Information

	Pi Toolset	Cosworth setup configuration software
-------------------------------------------------------------------------------------	------------	---------------------------------------

CDU 10.3

Dimensions

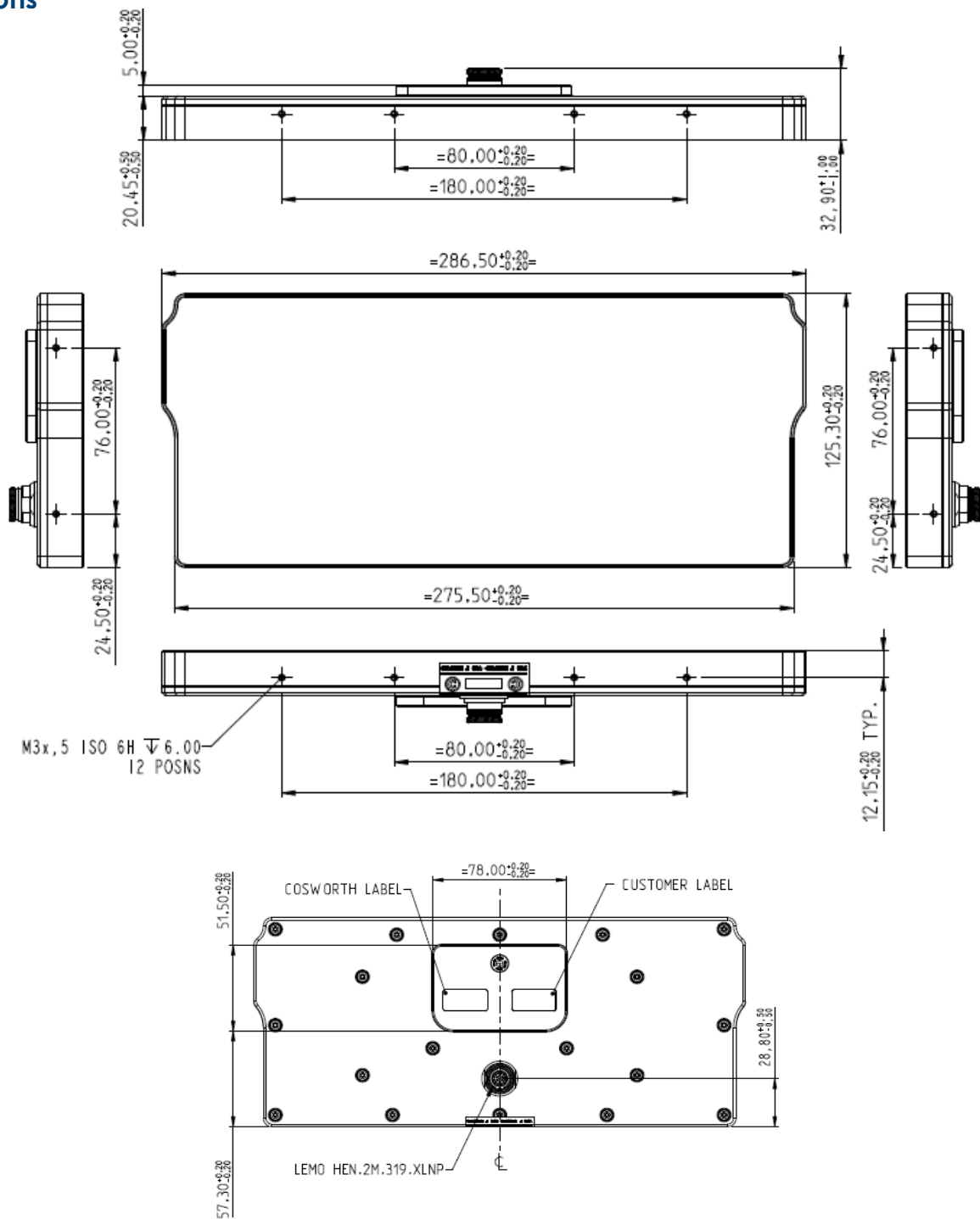

Installation

- Ensure unit is protected against severe vibrations by utilising AV mounts. Also ensure unit is not fouling other structures which may experience severe vibrations.
- Ensure unit is positioned in an area with sufficient cooling air flow to prevent over heating.
- Ensure unit is mounted away from sources of electrical interference.
- Ensure unit is mounted in position where unit will not come into contact with liquids.

CDU 10.3

Connector Information

Please note, pin allocation is in functional order not pin number order.

CN1

Connector	Mating Connector
HEN.2M.319.XLNP	FMN.2M.319.XLCT

Pin	CDU 10.3	Description
1	TX+1	Ethernet 100BaseT TX1
12	TX-1	
2	RX+1	Ethernet 100BaseT RX1
13	RX-1	
4	TX+2	Ethernet 100BaseT TX2
15	TX-2	
5	RX+2	Ethernet 100BaseT RX2
6	RX-2	
7	RS232 RX	RS232 Serial comms receive data (external to CDU)
16	RS232 TX	RS232 Serial comms transmit data (CDU to external)
8	USB VBUS	USB Data
9	USB Data +	
10	USB Data -	
17	USB Gnd	
11	BATT+	Battery Supply
18	Gnd	Grounds
19	Gnd	
3	N/A	Not available
14	N/A	

Recycling and Environmental Protection

Cosworth Electronics is committed to conducting its business in an environmentally responsible manner and strive for high environmental standards.

Manufacture

Cosworth products comply with the appropriate requirements of the Restriction of Hazardous Substance (RoHS)

Disposal

Electronic equipment should be disposed of on accordance with the regulations in force and in particular on accordance with the Waste in Electrical and Electronic Equipment directive. (WEEE).



T (UK) +44 (0) 1954 235 600 | **T (US)** +1 (317) 644 1037
E sales@cosworth.com | www.cosworth.com

© Copyright Cosworth Electronics Ltd | All Content is
Proprietary and Confidential. Brookfield Technology Centre,
Twentyence Road, Cottenham, Cambridge, CB24 8PS.